



13-15 Southbourne Lane East

, Southbourne, BH6 3DN

£895 PCM



Road Map



Hybrid Map



Terrain Map



Floor Plan

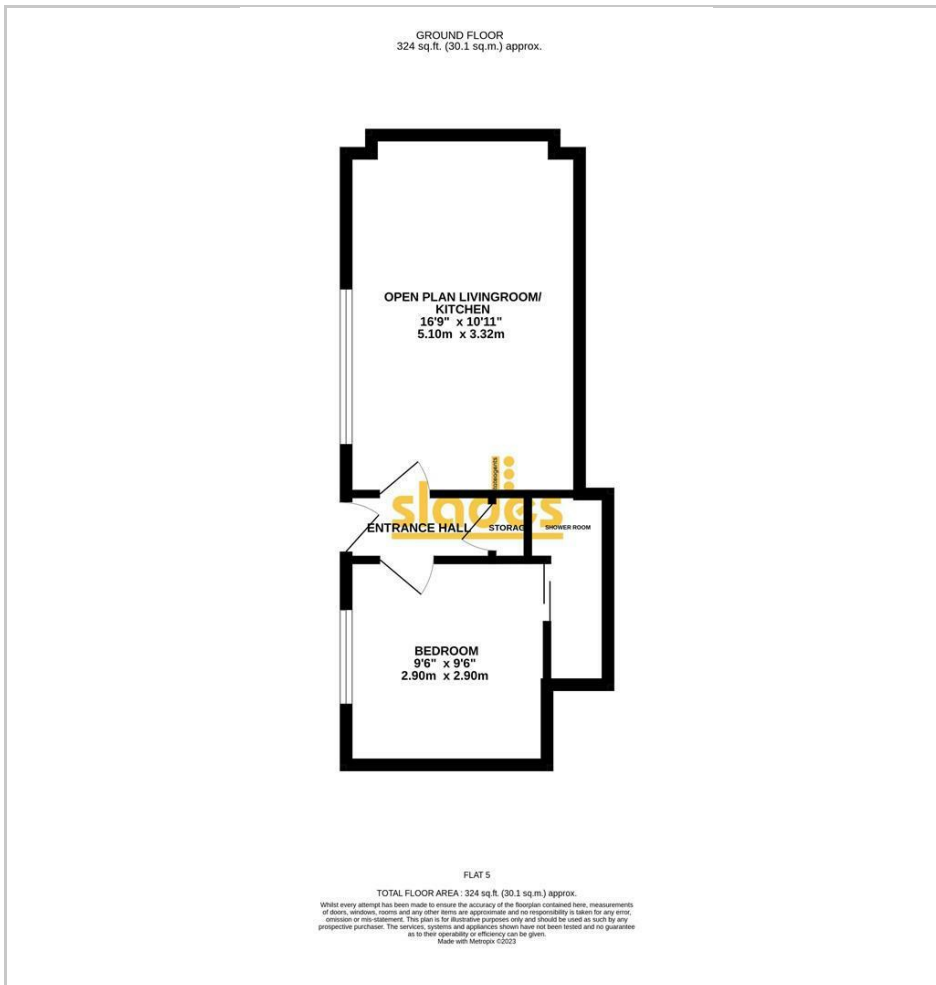

- AVAILABLE NOW
- MODERN (COMPACT) 1 BEROOM APARTMENT
- PRIVATE ENTRANCE
- DOUBLE BEDROOM
- SHOWER ROOM
- uPVC DOUBLE GLAZING
- MODERN ELECTRIC HEATING
- COUNCIL TAX BAND A
- EPC RATING D
- NO PARKING

Viewing

Please contact our Slades Estate Agents Office on 01202548855 if you wish to arrange a viewing appointment for this property or require further information.



These particulars, whilst believed to be accurate are set out as a general outline only for guidance and do not constitute any part of an offer or contract. Intending purchasers should not rely on them as statements of representation of fact, but must satisfy themselves by inspection or otherwise as to their accuracy. No person in this firms employment has the authority to make or give any representation or warranty in respect of the property.

301 Wimborne Road, Bournemouth, BH9 2AA
Tel: 01202548855 Email: info@sladesproperty.co.uk <https://www.sladesproperty.co.uk>

Energy Efficiency Graph

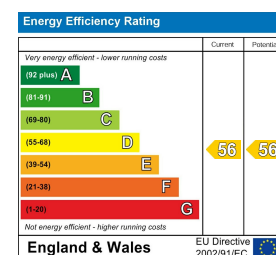

AVAILABLE NOW. A bright and spacious 1 double bedroom apartment with its own private entrance situated within walking distance to Southbourne Highstreet and Clifftop.

